

**NOTICE!!**

**These documents have been scanned!**

**Do not place un-scanned documents beneath this notice!**

**Do not remove this notice from this file!**

GPO Jacket No. 560-102  
Print Order 61540  
Rise Business Services, LLC  
Job=AZ15 4/30/2019



Box Number= AZ15011



Claim Begin-End: AMC441245-AMC441246

1 Initial Receipt



AZ15011-7

AMC450400-AMC453366

**AMC #****DATE CLOSED****ADJ INITIAL**

REMARKS

[illegible]



**United States Department of the Interior**  
**Bureau of Land Management**  
 DIV OF LANDS, MINRLS & ENERGY  
 ONE N CENTRAL AVE  
 PHOENIX, AZ 85004 -4427  
 Phone: 602-417-9200

Receipt

No: 3754026

**Transaction #:** 3859881**Date of Transaction:** 02/01/2017

CUSTOMER:

RICHARD BELVINS  
 PO BOX 1673  
 CLAYPOOL, AZ 85532-1673 US

**ENTERED**  
**FEB 06 2017**  
 By: *R. Belvins*

LINE #	QTY	DESCRIPTION	REMARKS	UNIT PRICE	TOTAL
1	2.00	LOCATABLE MINERALS / MINING CLAIMS-NEW, UNADJUD, ONE OR MORE AUTH NOS / NEW MINING CLAIM PROCESSING FEE <b>CASES:</b> AMC441245/\$20.00, AMC441246/\$20.00		- n/a -	40.00
2	2.00	LOCATABLE MINERALS / MINING CLAIMS-NEW, UNADJUD, ONE OR MORE AUTH NOS / NEW MINING CLAIMS LOCATION FEE <b>CASES:</b> AMC441245/\$37.00, AMC441246/\$37.00		- n/a -	74.00
3	2.00	LOCATABLE MINERALS / MINING CLAIMS-NEW, UNADJUD, ONE OR MORE AUTH NOS / NEW MINING CLAIMS MAINTENANCE FEE <b>CASES:</b> AMC441245/\$155.00, AMC441246/\$155.00		- n/a -	310.00
4	1.00	LOCATABLE MINERALS / MINING CLAIMS-NOT NEW-UNADJUD, ONE AUTH NO. ONLY / MINING CLAIM MONEY RECEIVED <b>CASES:</b> AMC441245/\$310.00	ADDITIONAL PLACER FEES	- n/a -	310.00
<b>TOTAL:</b>					<b>\$734.00</b>

## PAYMENT INFORMATION

1	AMOUNT:	734.00	POSTMARKED:	N/A
	TYPE:	CASH	RECEIVED:	02/01/2017

NAME:	BELVINS, RICHARD PO BOX 1673 CLAYPOOL AZ 85532-1673 US
-------	--

REMARKS
---------

This receipt was generated by the automated BLM Collections and Billing System and is a paper representation of a portion of the official electronic record contained therein.



**NOTICE!!**

**These documents have been scanned!**

**Do not place un-scanned documents beneath this notice!**

**Do not remove this notice from this file!**

GPO Jacket No. 560-102  
Print Order 61540  
Rise Business Services, LLC  
Job=AZ15 4/30/2019



Box Number= AZ15011



Claim Begin-End: AMC441245-AMC441246

2 Correspondence



AZ15011-7

AMC450400-AMC453366

**NO  
DOCUMENTS  
FOUND**

NO DOCUMENTS FOUND  
NO DOCUMENTS FOUND



**NOTICE!!**

**These documents have been scanned!**

**Do not place un-scanned documents beneath this notice!**

**Do not remove this notice from this file!**

GPO Jacket No. 560-102  
Print Order 61540  
Rise Business Services, LLC  
Job=AZ15 4/30/2019



Box Number= AZ15011



Claim Begin-End: AMC441245-AMC441246

3 Transfers



AZ15011-7

AMC450400-AMC453366

**NO  
DOCUMENTS  
FOUND**

NO DOCUMENTS FOUND  
NO DOCUMENTS FOUND



**NOTICE!!**

**These documents have been scanned!**

**Do not place un-scanned documents beneath this notice!**

**Do not remove this notice from this file!**

GPO Jacket No. 560-102  
Print Order 61540  
Rise Business Services, LLC  
Job=AZ15 4/30/2019



Box Number= AZ15011



Claim Begin-End: AMC441245-AMC441246

4 Annual Filings



AZ15011-7

AMC450400-AMC453366



UNITED STATES  
DEPARTMENT OF THE INTERIOR  
BUREAU OF LAND MANAGEMENT

MAINTENANCE FEE WAIVER CERTIFICATION

SEE INSTRUCTIONS ON PAGE 2

441245  
FORM APPROVED  
OMB NO. 1004-0114  
Expires: January 31, 2020

1. This small miner waiver is filed for the assessment year beginning on September 1, 2019 and ending on September 1, 2020.
2. The undersigned and all related parties owned ten or fewer mining claims, mill, or tunnel sites located and maintained on Federal lands in the United States of America on September 1, 2019.
3. The undersigned have performed the assessment work required by law for each mining claim listed prior to filing this waiver and understand that by filing this form, the undersigned must file an affidavit of assessment work with the Bureau of Land Management (BLM) by the December 30th following the filing of this waiver.
4. The undersigned understand that if the assessment work obligation has not yet come due under 30 U.S.C. 28 (for those claims in their first assessment year only), a notice of intent to hold reciting this condition must be recorded by the December 30th following the filing of this waiver.
5. The undersigned understand that mill and tunnel sites may also be listed on this waiver and be waived from payment of the maintenance fee, and that a notice of intent to hold for these sites is required to be filed with the BLM by the December 30th following the filing of this waiver.
6. The undersigned understand and acknowledge that pursuant to 43 U.S.C. 1212 and 18 U.S.C. 1001, the filing or recording of a false, fictitious, or fraudulent document with the BLM may result in a fine of up to \$250,000, a prison term not to exceed five years, or both.
7. The mining claims, mill or tunnel sites for which this waiver from payment of the maintenance fees is requested are:

CLAIM OR SITE NAME	BLM RECORDATION SERIAL NUMBER
1. <u>49ers #1</u>	<u>441245</u>
2. <u>49ers #2</u>	<u>441246</u>
3.	
4.	
5.	
6.	
7.	
8.	
9.	
10.	

The owner(s) (claimants) of the above mining claims and sites are:

<u>Richard Blevins</u> (Owner's Name - Please Print)	<u>Richard Blevins</u> (Owner's Signature)
<u>PO Box 1673 Claypool Az 85532</u> (Owner's Mailing Address)	<u>Claypool</u> <u>AZ</u> <u>85532</u> (City) (State) (Zip Code)
<u>Tina Heck</u> (Owner's Name - Please Print)	<u>Tina Heck</u> (Owner's Signature)
<u>PO Box 130 Claypool Az 85532</u> (Owner's Mailing Address)	<u>Claypool</u> <u>AZ</u> <u>85532</u> (City) (State) (Zip Code)
_____ (Owner's Name - Please Print)	_____ (Owner's Signature)
_____ (Owner's Mailing Address)	_____ (City) (State) (Zip Code)
_____ (Owner's Name - Please Print)	_____ (Owner's Signature)
_____ (Owner's Mailing Address)	_____ (City) (State) (Zip Code)

(Continued on page 2)

2019 JUN - 3 A 9-50

RECEIVED  
AZ STATE OFFICE

ENTERED  
SEP 12 2019  
BY: [Signature]

[Signature]



(Owner's Name - Please Print)	(Owner's Signature)		
(Owner's Mailing Address)	(City)	(State)	(Zip Code)
(Owner's Name - Please Print)	(Owner's Signature)		
(Owner's Mailing Address)	(City)	(State)	(Zip Code)
(Owner's Name - Please Print)	(Owner's Signature)		
(Owner's Mailing Address)	(City)	(State)	(Zip Code)
(Owner's Name - Please Print)	(Owner's Signature)		
(Owner's Mailing Address)	(City)	(State)	(Zip Code)

18 U.S.C. 1001 and 43 U.S.C. 1212 make it a crime for any person knowingly and willfully to make to any department or agency of the United States any false, fictitious or fraudulent statements or representations as to any matter within its jurisdiction.

#### INSTRUCTIONS

1. This certification is made under the provisions of 43 U.S.C. § 1744 and 30 U.S.C. § 28-28k and the regulations thereunder (43 CFR Part 3830).
2. The claimant(s) must fill in the dates in paragraph 1 for the beginning and ending of the assessment year for which this waiver is sought.
3. The claimant(s) must fill in the date in paragraph 2 for the beginning of the assessment year for which this waiver is sought.
4. All claim and site names and BLM serial numbers must be listed for the mining claims, mill sites, and tunnel sites for which the waiver is sought.
5. All owners of the mining claims, mill sites, and tunnel sites and their addresses must be given.
6. This waiver form must be signed by all the claimants or their designated agent, in original form. If an agent is designated, a notarized designation of agent, signed by all of the claimants with proper address given, must be submitted with this waiver.
7. This form must be filed no later than September 1st for the upcoming assessment year in the BLM State Office where the mining claims or sites are recorded, or the waiver cannot be granted by the BLM. (Example: To obtain a waiver for the assessment year 2012, which begins on September 1, 2011, you must qualify for and file for a waiver no later than September 1, 2011, in the proper BLM State Office.)
8. For all mining claims which require assessment work, you must record an affidavit of labor on or before the December 30th immediately following the filing of this waiver. For all other mining claims or sites waived, you must record a notice of intent to hold on or before the December 30th immediately following the filing of this waiver.
9. Mill and tunnel sites may also be listed on this waiver and be waived from payment of the maintenance fee. A notice of intent to hold for these sites is required to be filed by the December 30th following the filing of this waiver.

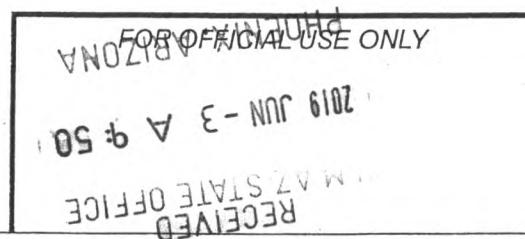

UNITED STATES  
DEPARTMENT OF THE INTERIOR  
BUREAU OF LAND MANAGEMENT

46

EXG

AMC 441245

MAINTENANCE FEE WAIVER CERTIFICATION

FORM APPROVED  
OMB NO. 1004-0114  
Expires: January 31, 2020

SEE INSTRUCTIONS ON PAGE 2

TH

1. This small miner waiver is filed for the assessment year beginning on September 1, 2018 and ending on September 1, 2019. TH
2. The undersigned and all related parties owned ten or fewer mining claims, mill, or tunnel sites located and maintained on Federal lands in the United States of America on September 1, 2018. TH
3. The undersigned have performed the assessment work required by law for each mining claim listed prior to filing this waiver and understand that by filing this form, the undersigned must file an affidavit of assessment work with the Bureau of Land Management (BLM) by the December 30th following the filing of this waiver.
4. The undersigned understand that if the assessment work obligation has not yet come due under 30 U.S.C. 28 (for those claims in their first assessment year only), a notice of intent to hold reciting this condition must be recorded by the December 30th following the filing of this waiver.
5. The undersigned understand that mill and tunnel sites may also be listed on this waiver and be waived from payment of the maintenance fee, and that a notice of intent to hold for these sites is required to be filed with the BLM by the December 30th following the filing of this waiver.
6. The undersigned understand and acknowledge that pursuant to 43 U.S.C. 1212 and 18 U.S.C. 1001, the filing or recording of a false, fictitious, or fraudulent document with the BLM may result in a fine of up to \$250,000, a prison term not to exceed five years, or both.
7. The mining claims, mill or tunnel sites for which this waiver from payment of the maintenance fees is requested are:

CLAIM OR SITE NAME	BLM RECORDATION SERIAL NUMBER
1. 49ers #1	441245
2. 49ers #2	441246
3.	
4.	
5.	
6.	
7.	
8.	
9.	
10.	

The owner(s) (claimants) of the above mining claims and sites are:

Richard Blevins

(Owner's Name - Please Print)

PO Box 1673 Claypool AZ 85532

(Owner's Mailing Address)

Richard Blevins

(Owner's Signature)

Claypool

(City)

AZ

(State)

85532

(Zip Code)

Tina Heck

(Owner's Name - Please Print)

PO Box 130

(Owner's Mailing Address)

Tina Heck

(Owner's Signature)

Claypool

(City)

AZ

(State)

85532

(Zip Code)

(Owner's Name - Please Print)

(Owner's Signature)

(Owner's Mailing Address)

(City)

(State)

(Zip Code)

(Owner's Name - Please Print)

(Owner's Signature)

(Owner's Mailing Address)

(City)

(State)

(Zip Code)

(Continued on page 2)

2018 MAY 11 A 10:44

RECEIVED  
STATE OFFICE

483  
ENTERED  
SEP 07 2018  
BY: [Signature]

[Signature]



(Owner's Name - Please Print)	(Owner's Signature)		
(Owner's Mailing Address)	(City)	(State)	(Zip Code)
(Owner's Name - Please Print)	(Owner's Signature)		
(Owner's Mailing Address)	(City)	(State)	(Zip Code)
(Owner's Name - Please Print)	(Owner's Signature)		
(Owner's Mailing Address)	(City)	(State)	(Zip Code)
(Owner's Name - Please Print)	(Owner's Signature)		
(Owner's Mailing Address)	(City)	(State)	(Zip Code)

18 U.S.C. 1001 and 43 U.S.C. 1212 make it a crime for any person knowingly and willfully to make to any department or agency of the United States any false, fictitious or fraudulent statements or representations as to any matter within its jurisdiction.

#### INSTRUCTIONS

1. This certification is made under the provisions of 43 U.S.C. § 1744 and 30 U.S.C. §28-28k and the regulations thereunder (43 CFR Part 3830).
2. The claimant(s) must fill in the dates in paragraph 1 for the beginning and ending of the assessment year for which this waiver is sought.
3. The claimant(s) must fill in the date in paragraph 2 for the beginning of the assessment year for which this waiver is sought.
4. All claim and site names and BLM serial numbers must be listed for the mining claims, mill sites, and tunnel sites for which the waiver is sought.
5. All owners of the mining claims, mill sites, and tunnel sites and their addresses must be given.
6. This waiver form must be signed by all the claimants or their designated agent, in original form. If an agent is designated, a notarized designation of agent, signed by all of the claimants with proper address given, must be submitted with this waiver.
7. This form must be filed no later than September 1st for the upcoming assessment year in the BLM State Office where the mining claims or sites are recorded, or the waiver cannot be granted by the BLM. (Example: To obtain a waiver for the assessment year 2012, which begins on September 1, 2011, you must qualify for and file for a waiver no later than September 1, 2011, in the proper BLM State Office.)
8. For all mining claims which require assessment work, you must record an affidavit of labor on or before the December 30th immediately following the filing of this waiver. For all other mining claims or sites waived, you must record a notice of intent to hold on or before the December 30th immediately following the filing of this waiver.
9. Mill and tunnel sites may also be listed on this waiver and be waived from payment of the maintenance fee. A notice of intent to hold for these sites is required to be filed by the December 30th following the filing of this waiver.

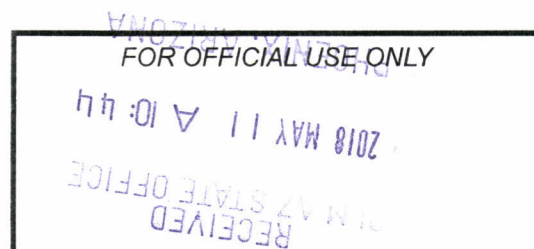

2  
When Recorded Return Document to:

Richard Blevins  
PO Box 1673  
Claypool AZ 85532

☐ Check here if this is a change of address.

Telephone: \_\_\_\_\_

E-mail address: \_\_\_\_\_



**FEE# 2018023279**

OFFICIAL RECORDS  
OF MOHAVE COUNTY  
KRISTI BLAIR,  
COUNTY RECORDER



05/08/2018 02:22 PM Fee: \$15.00

PAGE: 1 of 2

**AFFIDAVIT OF PERFORMANCE OF ANNUAL WORK**

1. State of Arizona, County of Mohave ss:

2. I (Name) Richard Blevins / Tina Heck

3. Reside at (Address) PO Box 1673 / PO Box 130

City Claypool County Gila

State AZ Zip 85532 being duly sworn, depose and say that I am a citizen of the United States, more than eighteen years of age, and that all of the facts set forth in this affidavit, subject to the provisions and penalties of 18 U.S.C. 1001 pertaining to the filing of false, fictitious, or fraudulent statements with the United States, are true and correct according to the best of my knowledge, information and belief.

4. Owner's name and address (If not shown in Items 1-3 above). \_\_\_\_\_

5. That I am personally acquainted with the mining claim(s). The work and improvements were made by and at the expense of the owner(s) of said claim(s). Said contiguous group of claims, listed on this document, are situated in the

\_\_\_\_\_ (optional) Mining District; Mohave County, Arizona.

Line No.	AMC NUMBER	CLAIM/SITE NAME	COUNTY RECORDER DATA (If available)	TWP	RNG	SEC
1	441246	49ers #1		15N	18W	28
2	441245	49ers #2		15N	18W	28
3						
4						
5						
6						

Form: MCF108  
Revised July 2014  
Page 1 of 2

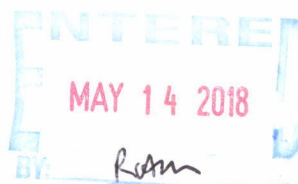



BLM Date Stamp	2018 MAY 11 A 10:11 PHOENIX, ARIZONA	RECEIVED
----------------------	---	----------

7						
8						
9						
10						

6. That between the dates starting at 12 o'clock noon on September 1, 20 17 and ending at 12 o'clock noon on September 1, 20 18 at least \$ 500.00 dollars worth of work and improvements were done and performed upon said claim(s) or upon one or more of a contiguous group of claims for the benefit of all, wholly or partly outside of a contiguous group of claims for the benefit of all, not including the location work.

7. That the following persons were employed to perform the work and improvements described herein: \_\_\_\_\_

Richard Blevins, Tina Heck

8. That the work and improvements performed were: exploratory work,  
clean up of property, repainted boundary markers.

9. Dated: 5-08-18 Signature: Tina Heck / Richard Blevins

SUBSCRIBED AND SWORN TO before me, a Notary Public, this 8<sup>th</sup> day of May 20 18

By: Tina Heck & Richard Blevins

Notary Public Hannah Blake

My Commission Expires 01-06-2019

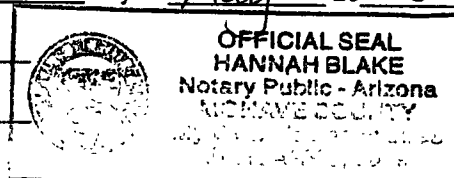

Bureau of Land Management  
Arizona State Office  
[www.blm.gov/az](http://www.blm.gov/az)

No. of Claims: 2 x \$10 = 20.00  
Check No.: Cash Init. AB  
Receipt No.: 4160735  
For BLM Use Only

**United States Department of the Interior**  
**Bureau of Land Management**  
DIV OF LANDS, MINRLS & ENERGY  
ONE N CENTRAL AVE  
PHOENIX, AZ 85004 -4427  
Phone: 602-417-9200

Receipt

No: 4160735

<b>Transaction #:</b> 4275007	
<b>Date of Transaction:</b> 05/11/2018	
<b>CUSTOMER:</b>	
	RICHARD BLEVINS PO BOX 1673 CLAYPOOL, AZ 85532-1673 US

LINE #	QTY	DESCRIPTION	REMARKS	UNIT PRICE	TOTAL
1	1.00	LOCATABLE MINERALS / MINING CLAIMS- NOT NEW-UNADJUD, ONE AUTH NO. ONLY / MINING CLAIM MONEY RECEIVED CASES: AMC441245/\$20.00	2018 POL & 2019 WAIV (2)	- n/a -	20.00
<b>TOTAL:</b>					<b>\$20.00</b>

PAYMENT INFORMATION				
1	AMOUNT:	20.00	POSTMARKED:	N/A
	TYPE:	CASH	RECEIVED:	05/11/2018
	NAME:	BLEVINS, RICHARD PO BOX 1673 CLAYPOOL AZ 85532-1673 US		

REMARKS

This receipt was generated by the automated BLM Collections and Billing System and is a paper representation of a portion of the official electronic record contained therein.



441245

When Recorded Return Document to:

Richard Blevins  
PO Box 1673  
Claypool, AZ 85532

**FEE# 2017037080**

OFFICIAL RECORDS  
OF MOHAVE COUNTY  
KRISTI BLAIR,  
COUNTY RECORDER



08/04/2017 10:10 AM Fee: \$15.00

PAGE: 1 of 2

☐ Check here is this is a change of address.

Telephone: \_\_\_\_\_

E-mail address: \_\_\_\_\_

**AFFIDAVIT OF PERFORMANCE OF ANNUAL WORK**

1. State of Arizona, County of Mohave ss:  
2. I (Name) Richard Blevins / Tina Heck  
3. Reside at (Address) PO Box 1673 / PO Box 130

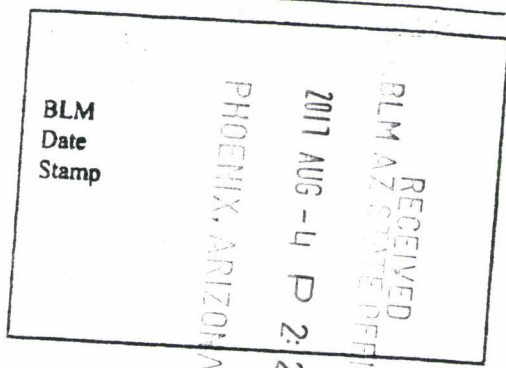

City Claypool County Gila

State AZ Zip 85532 being duly sworn, depose and say that I am a citizen of the United States, more than eighteen years of age, and that all of the facts set forth in this affidavit, subject to the provisions and penalties of 18 U.S.C. 1001 pertaining to the filing of false, fictitious, or fraudulent statements with the United States, are true and correct according to the best of my knowledge, information and belief.

4. Owner's name and address (if not shown in Items 1-3 above), \_\_\_\_\_

5. That I am personally acquainted with the mining claim(s). The work and improvements were made by and at the expense of the owner(s) of said claim(s). Said contiguous group of claims, listed on this document, are situated in the \_\_\_\_\_

(optional) Mining District: Mohave County, Arizona.

Line No.	AMC NUMBER	CLAIM/SITE NAME	COUNTY RECORDER DATA (If available)	TWP	RNG	SEC
1	441246	49ers #1		15N	18W	28
2	441245	49ers #2		15N	18W	28
3						
4						
5						
6						

**ENTERED**  
Action Remedy  
CORRECTED Year (2017)  
**JAN 25 2018**  
BY: PB

**ENTERED** Form: MCF108  
Revised Jan. 2006  
**AUG 07 2017**  
Page 1 of 2  
BY: R.A.M.

RECEIVED  
BLM STATE OFFICE  
2017 AUG -4 P 2:20  
PHOENIX, ARIZONA  
BLM  
Date  
Stamp

7						
8						
9						
10						

6. That between the dates starting at 12 o'clock noon on September 1, 2016 and ending at 12 o'clock noon on September 1, 2017 at least \$ 400.00 dollars worth of work and improvements were done and performed upon said claim(s) or upon one or more of a contiguous group of claims for the benefit of all, wholly or partly outside of a contiguous group of claims for the benefit of all, not including the location work.

7. That the following persons were employed to perform the work and improvements described herein:  
Richard Blevins, Tina Heck, Addie Heck, Jesse Heck, Henry Blevins

8. That the work and improvements performed were: tunnel work, exploratory work, clean up property, check and reset boundary markers.

9. Dated: 8-04-17 Signature: Richard Blevins day of August 20 17

SUBSCRIBED AND SWORN TO before me, a Notary Public, this 4

By: Richard Blevins and Tina Heck

Notary Public Hannah Blake

My Commission Expires 01-06-2019

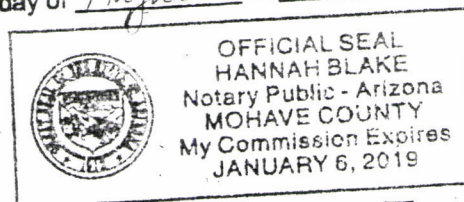

Bureau of Land Management  
Arizona State Office  
[www.az.blm.gov](http://www.az.blm.gov)

No. of Claims: \_\_\_\_\_ x \$10 = \_\_\_\_\_  
Check No.: \_\_\_\_\_ Init. \_\_\_\_\_  
Receipt No.: \_\_\_\_\_  
For BLM Use Only

Form: MCF108  
Revised Jan. 2006  
Page 2 of 2



**United States Department of the Interior**  
**Bureau of Land Management**  
DIV OF LANDS, MINRLS & ENERGY  
ONE N CENTRAL AVE  
PHOENIX, AZ 85004 -4427  
Phone: 602-417-9200

Receipt

No: 3922437

<b>Transaction #:</b> 4031947	
<b>Date of Transaction:</b> 08/04/2017	
<b>CUSTOMER:</b>	
	RICHARD BLEVINS PO BOX 1673 CLAYPOOL, AZ 85532-1673 US

LINE #	QTY	DESCRIPTION	REMARKS	UNIT PRICE	TOTAL
1	1.00	LOCATABLE MINERALS / MINING CLAIMS- NOT NEW-UNADJUD, ONE AUTH NO. ONLY / MINING CLAIM MONEY RECEIVED CASES: AMC441246/\$20.00	2017 AFFADAVIT/2	- n/a -	20.00
<b>TOTAL:</b>					<b>\$20.00</b>

PAYMENT INFORMATION				
1	AMOUNT:	20.00	POSTMARKED:	N/A
	TYPE:	CASH	RECEIVED:	08/04/2017
	NAME:	BLEVINS, RICHARD PO BOX 1673 CLAYPOOL AZ 85532-1673 US		

<b>REMARKS</b>

This receipt was generated by the automated BLM Collections and Billing System and is a paper representation of a portion of the official electronic record contained therein.

UNITED STATES  
DEPARTMENT OF THE INTERIOR  
BUREAU OF LAND MANAGEMENT  
**MAINTENANCE FEE WAIVER CERTIFICATION**

441245  
FORM APPROVED  
OMB NO. 1004-0114  
Expires: January 31, 2020

SEE INSTRUCTIONS ON PAGE 2

1. This small miner waiver is filed for the assessment year beginning on September 1, 2017 and ending on September 1, 2018.
2. The undersigned and all related parties owned ten or fewer mining claims, mill, or tunnel sites located and maintained on Federal lands in the United States of America on September 1, 2017.
3. The undersigned have performed the assessment work required by law for each mining claim listed prior to filing this waiver and understand that by filing this form, the undersigned must file an affidavit of assessment work with the Bureau of Land Management (BLM) by the December 30th following the filing of this waiver.
4. The undersigned understand that if the assessment work obligation has not yet come due under 30 U.S.C. 28 (for those claims in their first assessment year only), a notice of intent to hold reciting this condition must be recorded by the December 30th following the filing of this waiver.
5. The undersigned understand that mill and tunnel sites may also be listed on this waiver and be waived from payment of the maintenance fee, and that a notice of intent to hold for these sites is required to be filed with the BLM by the December 30th following the filing of this waiver.
6. The undersigned understand and acknowledge that pursuant to 43 U.S.C. 1212 and 18 U.S.C. 1001, the filing or recording of a false, fictitious, or fraudulent document with the BLM may result in a fine of up to \$250,000, a prison term not to exceed five years, or both.
7. The mining claims, mill or tunnel sites for which this waiver from payment of the maintenance fees is requested are:

CLAIM OR SITE NAME	BLM RECORDATION SERIAL NUMBER
1. <u>49ers #1</u>	<u>AMC 441246</u>
2. <u>49ers #2</u>	<u>AMC 441245</u>
3.	
4.	
5.	
6.	
7.	
8.	
9.	
10.	

The owner(s) (claimants) of the above mining claims and sites are:

Richard Blevins

(Owner's Name - Please Print)

PO Box 1673

(Owner's Mailing Address)

Richard Blevins

(Owner's Signature)

Claypool

(City)

AZ

(State)

85532

(Zip Code)

Tina Heck

(Owner's Name - Please Print)

PO Box 130

(Owner's Mailing Address)

Dunattek

(Owner's Signature)

Claypool

(City)

AZ

(State)

85532

(Zip Code)

(Owner's Name - Please Print)

(Owner's Signature)

(Owner's Mailing Address)

(City)

(State)

(Zip Code)

(Owner's Name - Please Print)

(Owner's Signature)

(Owner's Mailing Address)

(City)

(State)

(Zip Code)

(Continued on page 2)

483  
ENTERED  
AUG 31 2017  
BY: RM

RECEIVED  
BLM AZ STATE OFFICE  
2017 AUG -4 P 2:20  
PHOENIX, ARIZONA

nm  
m



(Owner's Name - Please Print)	(Owner's Signature)		
(Owner's Mailing Address)	(City)	(State)	(Zip Code)
(Owner's Name - Please Print)	(Owner's Signature)		
(Owner's Mailing Address)	(City)	(State)	(Zip Code)
(Owner's Name - Please Print)	(Owner's Signature)		
(Owner's Mailing Address)	(City)	(State)	(Zip Code)
(Owner's Name - Please Print)	(Owner's Signature)		
(Owner's Mailing Address)	(City)	(State)	(Zip Code)

18 U.S.C. 1001 and 43 U.S.C. 1212 make it a crime for any person knowingly and willfully to make to any department or agency of the United States any false, fictitious or fraudulent statements or representations as to any matter within its jurisdiction.

#### INSTRUCTIONS

1. This certification is made under the provisions of 43 U.S.C. § 1744 and 30 U.S.C. §28-28k and the regulations thereunder (43 CFR Part 3830).
2. The claimant(s) must fill in the dates in paragraph 1 for the beginning and ending of the assessment year for which this waiver is sought.
3. The claimant(s) must fill in the date in paragraph 2 for the beginning of the assessment year for which this waiver is sought.
4. All claim and site names and BLM serial numbers must be listed for the mining claims, mill sites, and tunnel sites for which the waiver is sought.
5. All owners of the mining claims, mill sites, and tunnel sites and their addresses must be given.
6. This waiver form must be signed by all the claimants or their designated agent, in original form. If an agent is designated, a notarized designation of agent, signed by all of the claimants with proper address given, must be submitted with this waiver.
7. This form must be filed no later than September 1st for the upcoming assessment year in the BLM State Office where the mining claims or sites are recorded, or the waiver cannot be granted by the BLM. (Example: To obtain a waiver for the assessment year 2012, which begins on September 1, 2011, you must qualify for and file for a waiver no later than September 1, 2011, in the proper BLM State Office.)
8. For all mining claims which require assessment work, you must record an affidavit of labor on or before the December 30th immediately following the filing of this waiver. For all other mining claims or sites waived, you must record a notice of intent to hold on or before the December 30th immediately following the filing of this waiver.
9. Mill and tunnel sites may also be listed on this waiver and be waived from payment of the maintenance fee. A notice of intent to hold for these sites is required to be filed by the December 30th following the filing of this waiver.

*FOR OFFICIAL USE ONLY*

**NOTICE!!**

**These documents have been scanned!**

**Do not place un-scanned documents beneath this notice!**

**Do not remove this notice from this file!**

GPO Jacket No. 560-102  
Print Order 61540  
Rise Business Services, LLC  
Job=AZ15 4/30/2019



Box Number= AZ15011



Claim Begin-End: AMC441245-AMC441246

5 Miscellaneous



AZ15011-7

AMC450400-AMC453366



**DEPARTMENT OF THE INTERIOR  
BUREAU OF LAND MANAGEMENT  
MINING CLAIMS**

Run Date/Time: 01/25/2018 08:25 AM

**(LIVE) Serial Register Page**

Page 1 of 1

**01 10-21-1976;090STAT0090;43USC1744**

**Total Acres**

**Serial Number**

**Case Type 384201: PLACER CLAIM**

**40.000**

**AMC441245**

**Claim Name: 49ERS #2**

**Lead File Number**

**Commodity :**

**AMC441245**

**Case Disposition: ACTIVE**

**Required Maintenance Fee: \$310.00**

**Name & Address**

**Int Rel**

BLEVINS RICHARD PO BOX 1673  
HECK TINA PO BOX 130

CLAYPOOL, AZ 85532-1673  
CLAYPOOL, AZ 85532-0130

CLAIMANT  
CLAIMANT

**Mer Twp Rng Sec Quadrant**

**District/Field Office**

**County**

14 0150N 0180W 028

SW

LAKE HAVASU FO

MOHAVE

**Act Date**

**Code Action**

**Action Remarks**

**Receipt Number**

01/28/2017

403

LOCATION DATE

02/01/2017

395

RECORDATION NOTICE RECD

1

3754026

08/04/2017

483

SMALL MINER CERT FILED

2018

02/01/2017

484

LOCATION YEAR / MAINTENANCE 2017;\$155

08/04/2017

480

EVID OF ASSMT FILED

2017

3922437

08/04/2017

170

ADDRESS CHANGE FILED

HECK TINA

02/17/2017

669

LAND STATUS CHECKED

02/01/2017

501

ACCT ADV IN LEAD FILE

AMC441245-AMC441246;

02/01/2017

685

ADDL MAINTENANCE FEE

2017;\$155

3754026

**Line Nr Remarks**

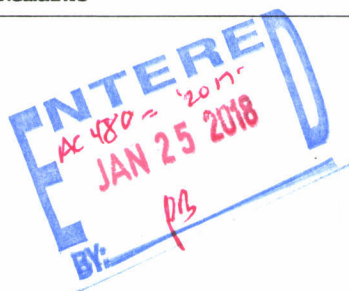

**DEPARTMENT OF THE INTERIOR  
BUREAU OF LAND MANAGEMENT  
MINING CLAIMS**

Run Date/Time: 01/25/2018 08:25 AM

**(LIVE) Serial Register Page**

Page 1 of 1

**01 10-21-1976;090STAT0090;43USC1744**

**Case Type 384201: PLACER CLAIM**

**Claim Name: 49ERS #1**

**Commodity :**

**Case Disposition: ACTIVE**

**Required Maintenance Fee: \$310.00**

**Total Acres**

**40.000**

**Serial Number**

**AMC441246**

**Lead File Number**

**AMC441245**

**Name & Address**

**Int Rel**

BLEVINS RICHARD PO BOX 1673  
HECK TINA PO BOX 130

CLAYPOOL, AZ 85532-1673  
CLAYPOOL, AZ 85532-0130

CLAIMANT  
CLAIMANT

**Mer Twp Rng Sec Quadrant**

**District/Field Office**

**County**

14 0150N 0180W 028 SW

LAKE HAVASU FO

MOHAVE

Act Date	Code	Action	Action Remarks	Receipt Number
----------	------	--------	----------------	----------------

01/28/2017	403	LOCATION DATE		
------------	-----	---------------	--	--

02/01/2017	395	RECORDATION NOTICE RECD	1	3754026
------------	-----	-------------------------	---	---------

08/04/2017	483	SMALL MINER CERT FILED	2018	
------------	-----	------------------------	------	--

02/01/2017	484	LOCATION YEAR / MAINTENANCE	2017;\$155	3754026
------------	-----	-----------------------------	------------	---------

08/04/2017	480	EVID OF ASSMT FILED	<u>2017</u>	3922437
------------	-----	---------------------	-------------	---------

08/04/2017	170	ADDRESS CHANGE FILED	HECK TINA	
------------	-----	----------------------	-----------	--

08/04/2017	392	MONIES RECEIVED	\$20.00;2	3922437
------------	-----	-----------------	-----------	---------

02/17/2017	669	LAND STATUS CHECKED		
------------	-----	---------------------	--	--

02/01/2017	501	ACCT ADV IN LEAD FILE	AMC441245-AMC441246;	
------------	-----	-----------------------	----------------------	--

02/01/2017	685	ADDL MAINTENANCE FEE	2017;\$155	3754026
------------	-----	----------------------	------------	---------

*Correction made  
1/25/2018  
panam*

**Line Nr Remarks**

*NOIS ES MAR*



## Mass Add/Delete/Update Action Data

Starting Serial Number Ending Serial Number

441245

441246

	Action Data:	
Action Code:	480	<b>Lookup</b>
Action Remark:	2017 Action 484 Amounts: <input type="radio"/> \$ <input type="text"/> <input type="radio"/> \$ <input type="text"/>	
Action Date:	08/04/2017	
Receipt Nr:	3922437	

**Add****Delete****Close**

[AMC441245] - [Placer] - 480 - 2017

[AMC441246] - [Placer] - 480 - 2017

=====

Total Amount Processed : \$0.00

	Update Action Data:	
Action Code:	<input type="text"/>	<b>Lookup</b>
Action Remark:	<input type="text"/>	
Action Date:	<input type="text"/>	
Receipt Nr:	<input type="text"/>	

**Update**

## Action Code Update

Serial-No: AMC441245

Status: ACTIVE

Bottom of Screen

	Del?	Date (mm/dd/yyyy)	Code	Action Taken	Action Remark	Receipt Nr	Ins User	Mod User
<input checked="" type="radio"/> 1	<input type="checkbox"/> X	01/28/2017	403	LOCATION DATE			RMATTSON	
<input type="radio"/> 2	<input type="checkbox"/> X	02/01/2017	395	RECORDATION NOTICE RECD	1	3754026	CBS_IMPT	
<input type="radio"/> 3	<input type="checkbox"/> X	08/04/2017	483	SMALL MINER CERT FILED	2018		RMYERS	
<input type="radio"/> 4	<input type="checkbox"/> X	08/04/2017	170	ADDRESS CHANGE FILED	HECK TINA		RMYERS	
<input type="radio"/> 5	<input type="checkbox"/> X	08/04/2017	480	EVID OF ASSMT FILED	(2018) 2017	3922437	RMATTSON	
<input type="radio"/> 6	<input type="checkbox"/> X	02/17/2017	669	LAND STATUS CHECKED			ATHROWER	
<input type="radio"/> 7	<input type="checkbox"/> X	02/01/2017	501	ACCT ADV IN LEAD FILE	AMC441245-AMC441246;		RMATTSON	
<input type="radio"/> 8	<input type="checkbox"/> X	02/01/2017	484	LOCATION YEAR / MAINTENANCE FEE	2017;\$155	3754026	RMATTSON	
<input type="radio"/> 9	<input type="checkbox"/> X	02/01/2017	685	ADDL MAINTENANCE FEE	2017;\$155	3754026	ATHROWER	

# Actions: 9

Provide me with ☒ new occurrences

Please SAVE&amp;CONTINUE Between DELETES and NEW/CHANGE Lines

Save &amp; Continue

Save &amp; Exit

Cancel

Lookup

CMR Lookup

Serial-No: AMC441245

Top of Screen



## Action Code Update

Serial-No: AMC441246

Status: ACTIVE

Bottom of Screen

	Del?	Date (mm/dd/yyyy)	Code	Action Taken	Action Remark	Receipt Nr	Ins User	Mod User
<input checked="" type="radio"/> 1	<input type="checkbox"/> x	01/28/2017	403	LOCATION DATE			RMATTSON	
<input type="radio"/> 2	<input type="checkbox"/> x	02/01/2017	395	RECORDATION NOTICE RECD		3754026	CBS_IMPT	
<input type="radio"/> 3	<input type="checkbox"/> x	08/04/2017	483	SMALL MINER CERT FILED	2018		RMYERS	
<input type="radio"/> 4	<input type="checkbox"/> x	08/04/2017	170	ADDRESS CHANGE FILED	HECK TINA		RMYERS	
<input type="radio"/> 5	<input type="checkbox"/> x	08/04/2017	480	EVID OF ASSMT FILED	2018 2017 <i>FIX</i>	3922437	RMATTSON	
<input type="radio"/> 6	<input type="checkbox"/> x	08/04/2017	913	MAINT WAIVER DOC FILED	2018		RMATTSON	
<input type="radio"/> 7	<input type="checkbox"/> x	02/17/2017	669	LAND STATUS CHECKED			ATHROWER	
<input type="radio"/> 8	<input type="checkbox"/> x	02/01/2017	501	ACCT ADV IN LEAD FILE	AMC441245-AMC441246;		RMATTSON	
<input type="radio"/> 9	<input type="checkbox"/> x	02/01/2017	484	LOCATION YEAR / MAINTENANCE FEE	2017;\$155	3754026	RMATTSON	
<input type="radio"/> 10	<input type="checkbox"/> x	02/01/2017	685	ADDL MAINTENANCE FEE	2017;\$155	3754026	ATHROWER	

# Actions: 10

Provide me with ☒ new occurrences

Please SAVE&amp;CONTINUE Between DELETES and NEW/CHANGE Lines

Save &amp; Continue

Save &amp; Exit

Cancel

Lookup

CMR Lookup

Serial-No: AMC441246

Top of Screen

8,9 ✓

**DEPARTMENT OF THE INTERIOR  
BUREAU OF LAND MANAGEMENT  
MINING CLAIMS**

Run Date/Time: 01/24/2018 08:01 AM

**(LIVE) Serial Register Page**

Page 28 of 29

01 10-21-1976;090STAT0090;43USC1744  
Case Type 384201: PLACER CLAIM  
Claim Name: 49ERS #2  
Commodity :  
Case Disposition: ACTIVE  
Required Maintenance Fee: \$310.00

Total Acres  
40.000

Serial Number  
AMC441245  
Lead File Number  
AMC441245

*JK*

Name & Address				Int Rel
BLEVINS RICHARD	PO BOX 1673	CLAYPOOL, AZ 85532-1673	CLAIMANT	
HECK TINA	PO BOX 130	CLAYPOOL, AZ 85532-0130	CLAIMANT	

Mer Twp	Rng	Sec	Quadrant	District/Field Office	County
14	0150N	0180W	028 SW	LAKE HAVASU FO	MOHAVE

Act Date	Code	Action	Action Remarks	Receipt Number
01/28/2017	403	LOCATION DATE		
02/01/2017	395	RECORDATION NOTICE RECD	1	3754026
08/04/2017	480	EVID OF ASSMT FILED	2018	3922437
08/04/2017	483	SMALL MINER CERT FILED	2018	
02/01/2017	484	LOCATION YEAR / MAINTENANC	2017;\$155	3754026
08/04/2017	170	ADDRESS CHANGE FILED	HECK TINA	
02/17/2017	669	LAND STATUS CHECKED		
02/01/2017	501	ACCT ADV IN LEAD FILE	AMC441245-AMC441246;	
02/01/2017	685	ADDL MAINTENANCE FEE	2017;\$155	3754026

*Pol Filed when an  
NOT was Required*

*YEARS  
Date Should be  
2017*

*Corrected  
1-25-18*

*Removal  
1-24-18*

Line Nr Remarks



**DEPARTMENT OF THE INTERIOR  
BUREAU OF LAND MANAGEMENT  
MINING CLAIMS**

Run Date/Time: 01/24/2018 08:01 AM

**(LIVE) Serial Register Page**

Page 29 of 29

01 10-21-1976;090STAT0090;43USC1744

Case Type 384201: PLACER CLAIM

Claim Name: 49ERS #1

Commodity :

Case Disposition: ACTIVE

Required Maintenance Fee: \$310.00

Total Acres

40.000

Serial Number

AMC441246

Lead File Number

AMC441245

Name & Address

Int Rel

BLEVINS RICHARD

PO BOX 1673

CLAYPOOL, AZ 85532-1673

CLAIMANT

HECK TINA

PO BOX 130

CLAYPOOL, AZ 85532-0130

CLAIMANT

Mer Twp Rng Sec

Quadrant

District/Field Office

County

14 0150N 0180W 028

SW

LAKE HAVASU FO

MOHAVE

Act Date	Code	Action	Action Remarks	Receipt Number
01/28/2017	403	LOCATION DATE		
02/01/2017	395	RECORDATION NOTICE RECD	1	3754026
08/04/2017	480	EVID OF ASSMT FILED	2018	3922437
08/04/2017	483	SMALL MINER CERT FILED	2018	
02/01/2017	484	LOCATION YEAR / MAINTENANC	2017;\$155 ✓	3754026
08/04/2017	170	ADDRESS CHANGE FILED	HECK TINA	
02/17/2017	669	LAND STATUS CHECKED		
02/01/2017	501	ACCT ADV IN LEAD FILE	AMC441245-AMC441246;	
02/01/2017	685	ADDL MAINTENANCE FEE	2017;\$155 ✓	3754026

Line Nr Remarks

NO WARRANTY IS MADE BY BLM  
FOR USE OF THE DATA FOR  
PURPOSES NOT INTENDED BY BLM



**NOTICE!!**

**These documents have been scanned!**

**Do not place un-scanned documents beneath this notice!**

**Do not remove this notice from this file!**

GPO Jacket No. 560-102  
Print Order 61540  
Rise Business Services, LLC  
Job=AZ15 4/30/2019



Box Number= AZ15011



Claim Begin-End: AMC441245-AMC441246

6 Location Notices-Amendments and Supporting Documents



AZ15011-7 AMC450400-AMC453366



# MINING CLAIM STATUS REPORT

Data Entered: 02/16/17 Rmn

MTP Checked By: MC  
GEO Checked By: MC

LEAD SERIAL NUMBER: AMC 441245 thru AMC 441246

## NUMBER OF CLAIMS & TYPE:

## CHARGES:

\_\_\_\_\_  
LODE  
\_\_\_\_\_  
PLACER  
2  
ASSOCIATION PLACER  
\_\_\_\_\_  
MILL SITE  
\_\_\_\_\_  
TUNNEL SITE

Location Fee @ \$37 = \$ 74  
Processing Fee @ \$20 = \$ 40  
Maintenance Fee @ \$155 = \$ 310  
Add'l Maint Fee for Assoc Placer = \$ 310

TOTAL ACREAGE: 40 Per Claim  
(Placer Only)

SUBTOTAL \$

NUMBER OF LOCATORS: 2

Other Fees \$

Other Fees \$

TOTAL \$ 734

DOCUMENTS RECEIVED VIA : Over-the-Counter ☒ Mail ☐ TIMELY FILED: Yes ☒ No ☐

LEGAL DESCRIPTION: T 15N R 18W SEC 28  
T \_\_\_\_\_ R \_\_\_\_\_ SEC \_\_\_\_\_  
T \_\_\_\_\_ R \_\_\_\_\_ SEC \_\_\_\_\_  
T \_\_\_\_\_ R \_\_\_\_\_ SEC \_\_\_\_\_  
T \_\_\_\_\_ R \_\_\_\_\_ SEC \_\_\_\_\_

BLM ☒ FOREST SERVICE ☐ SUBJ TO PL 359: Yes ☐ No ☐  
WILDERNESS AREA ☐

SPLIT ESTATE: N/A ☒ SX ☐ PX ☐ OTHER ☐  
SRHA ☐ Was proper Notice filed if located on SHRA Land? Yes ☐ No ☐

## RECONVEYED MINERALS ON BLM LAND REQUIRE OPENING ORDER FROM 1944 TO 1993:

Open to Entry On \_\_\_\_\_ N/A ☐

COMMENTS/STATUS: VOID ☐ PARTIALLY VOID ☐ PVT MINERALS ☐ WITHDRAWN LANDS ☐  
OTHER ☐

[ ] Claimant acknowledges that portions of the following claim(s) site(s) may be void or voidable.

Printed Name of Claimant \_\_\_\_\_ Signature of Claimant \_\_\_\_\_

\*\*\*\*\*FINAL ADJUDICATION\*\*\*\*\*

DATE 2/17/17 INITIALS AT

AMC441245

**LOCATION NOTICE FOR PLACER MINING CLAIM**

☐ Amendment BLM Serial # \_\_\_\_\_

NOTICE IS HEREBY GIVEN that the 49ers #2

\_\_\_\_\_ placer mining-claim has been located by

Tina Heck/Richard Blevins whose current mailing

address is PO Box 1673

Claypool AZ 85532

BLM  
Date  
Stamp

PHOENIX, ARIZONA

2017 FEB - 1 P 12: 10

RECEIVED  
BLM AZ STATE OFFICE

The general course of this claim is West to East and it is situated in Mohave  
County, Arizona. This claim is 1320 feet in length and 1320 feet in width.

40 Total Claim Acreage. This claim runs from the location monument on which this location notice is  
posted at the SW corner of the claim approximately 1320 feet in a East direction to the  
SE end line and 1320 feet in a NORTH direction to the NE end line. This claim is  
marked by four monuments, one at each corner of the claim.

The location monument on which this notice is posted is situated within Section 28, Township  
15 N, Range 18 W, Gila Salt River Base and Meridian, Arizona. This claim encompasses

portions of the following legal subdivision(s) if located by legal subdivision or the following quarter section(s),  
section(s), Township(s) and Range(s) NW<sup>1</sup>/<sub>4</sub> SW<sup>1</sup>/<sub>4</sub> 15N 18W, Sec 28

\_\_\_\_\_, Gila Salt River Base and Meridian, Arizona.

The locality of this claim with reference to some natural object or permanent monument and additional information  
(if any) concerning its locality are as follows: 1320 ft North

of the Section Corner of Section 28-29-32-33

\_\_\_\_\_. The above information is shown on the attached map.

DATED AND POSTED on the ground this 28 day of Jan, 2017.

☒ LOCATOR(s) ☐ AGENT

Print Name(s) Tina Heck Richard Blevins

Signature(s) Tina Heck Richard Blevins

Form MCF102  
Revised July 2014

This form is available from the Arizona Geological Survey and may be reproduced.

AMC441245



# MINING CLAIM MAP

Lode ( ) Placer ( )  
Millsite ( )

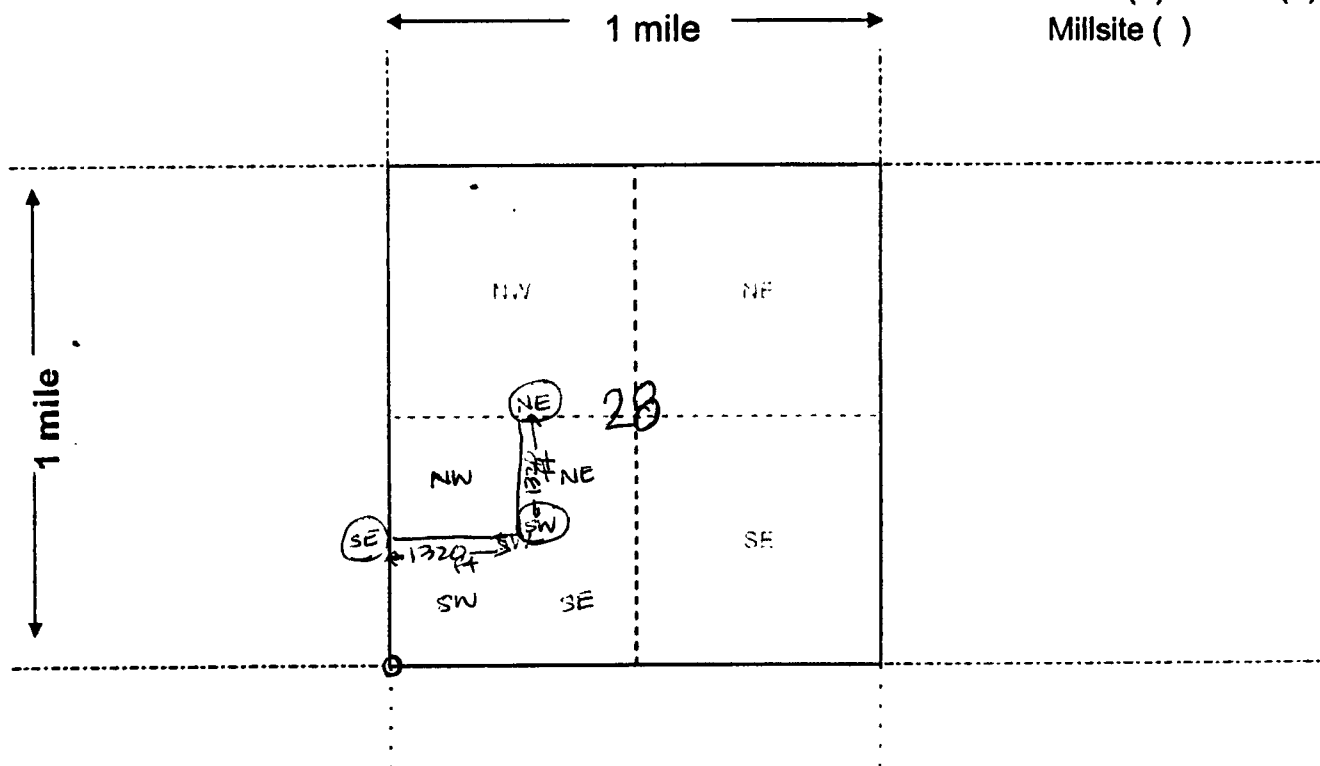

Scale: 1" = 2000 feet



- The above map depicts the 49ers #2 mining claim, which is located in Section (s) 28, Township 15 N, Range 18 W, Gila and Salt River Base and Meridian, Mohave County, Arizona. Total claim acreage is 40 acres
- The type of corner and location monuments used are as follows: A post painted white

3. The bearings and distances in degrees and feet between claim corners and to a public land survey monument are as depicted on the map.

4. If the claim is a placer or millsite claim with exterior limits conforming to legal subdivisions of the public survey, provide a legal description of the claim NW Corner of the SW quadrant  
Section 28, township 15N, range 18W.

Form MCF100a  
Revised July 2014

LOCATION NOTICE FOR PLACER MINING CLAIM

☐ Amendment BLM Serial # \_\_\_\_\_

NOTICE IS HEREBY GIVEN that the 49ers #2

\_\_\_\_\_ placer mining claim has been located by

Tina Heck/Richard Blevins whose current mailing

address is PO Box 1673

Claypool AZ 85532

BLM  
Date  
Stamp

PHOENIX, ARIZONA

2017 FEB - 1 P 12:10

RECEIVED  
BLM AZ STATE OFFICE

The general course of this claim is West to East and it is situated in Mohave

County, Arizona. This claim is 1320 feet in length and 1320 feet in width.

40 Total Claim Acreage. This claim runs from the location monument on which this location notice is posted at the SW corner of the claim approximately 1320 feet in a East direction to the SE end line and 1320 feet in a NORTH direction to the NE end line. This claim is marked by four monuments, one at each corner of the claim.

The location monument on which this notice is posted is situated within Section 28, Township

15 N, Range 18 W, Gila Salt River Base and Meridian, Arizona. This claim encompasses

portions of the following legal subdivision(s) if located by legal subdivision or the following quarter section(s),

section(s), Township(s) and Range(s) NW 1/4 SW 1/4, 15N, 18W, Sec 28

\_\_\_\_\_, Gila Salt River Base and Meridian, Arizona.

The locality of this claim with reference to some natural object or permanent monument and additional information (if any) concerning its locality are as follows: 1320 ft North

of the Section Corner of Section 28 29 32 33

\_\_\_\_\_. The above information is shown on the attached map.

DATED AND POSTED on the ground this 28 day of Jan, 2017.

☒ LOCATOR(s) ☐ AGENT

Print Name(s) Tina Heck Richard Blevins

Signature(s) Tina Heck Richard Blevins

Form MCF102  
Revised July 2014

This form is available from the Arizona Geological Survey and may be reproduced.

AMC441245



# MINING CLAIM MAP

Lode ( ) Placer ( )  
Millsite ( )

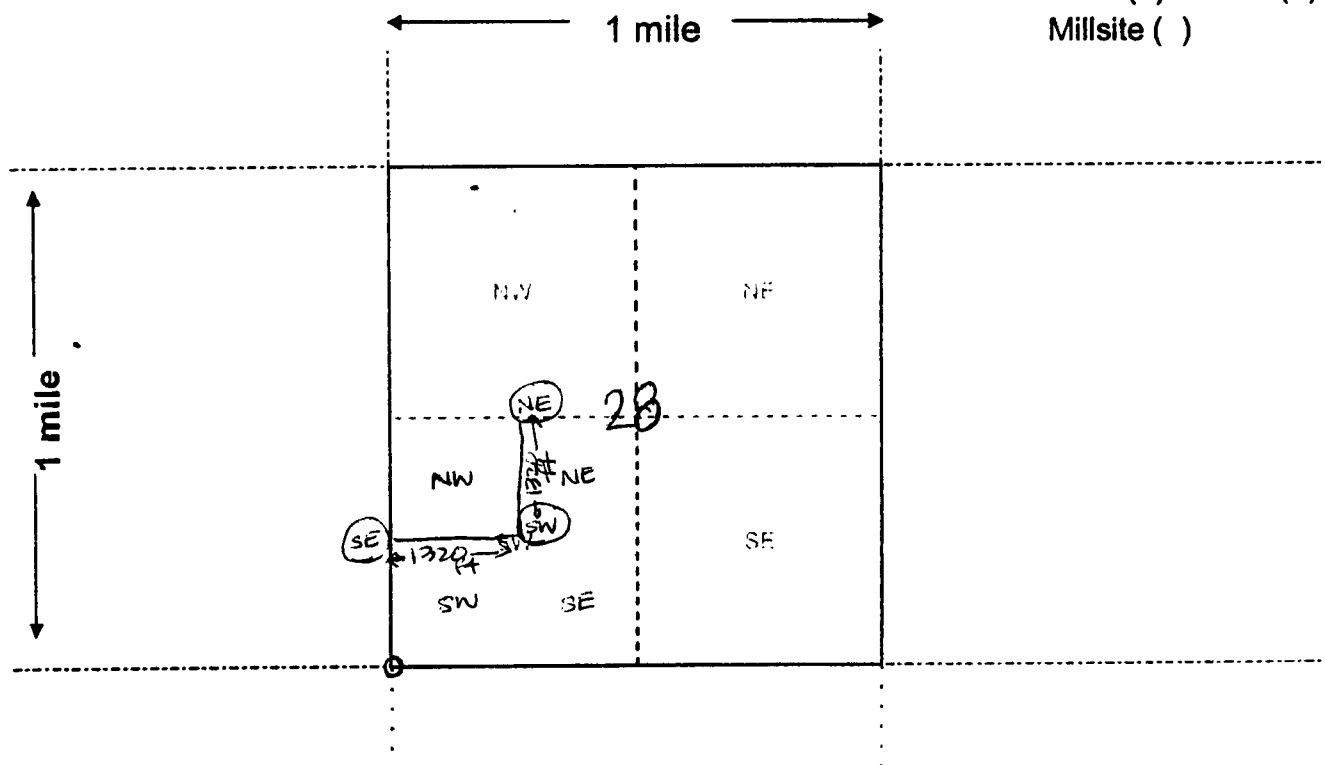

Scale: 1" = 2000 feet

1. The above map depicts the 49ers #2 mining claim, which is located in Section (s) 28, Township 15 N, Range 18 W, Gila and Salt River Base and Meridian, Mohave County, Arizona. Total claim acreage is 40 acres

2. The type of corner and location monuments used are as follows: A post painted white

3. The bearings and distances in degrees and feet between claim corners and to a public land survey monument are as depicted on the map.

4. If the claim is a placer or millsite claim with exterior limits conforming to legal subdivisions of the public survey, provide a legal description of the claim SW Corner of the SW quadrant  
Section 28, township 15N, range 18W.

Form MCF100a  
Revised July 2014

**LOCATION NOTICE FOR PLACER MINING CLAIM**

☐ Amendment BLM Serial # \_\_\_\_\_

NOTICE IS HEREBY GIVEN that the 49ers #1

\_\_\_\_\_ placer mining claim has been located by

Tina Heck / Richard Blevins whose current mailing  
address is PO Box 130

Claypool AZ 85532

BLM  
Date  
Stamp

PHOENIX, ARIZONA

2017 FEB - 1 P 12: 10

RECEIVED  
BLM AZ STATE OFFICE

The general course of this claim is West to East and it is situated in Mohave  
County, Arizona. This claim is 1320 feet in length and 1320 feet in width.

40 Total Claim Acreage. This claim runs from the location monument on which this location notice is  
posted at the NW corner of the claim approximately 1320 feet in a East direction to the  
NE end line and 1320 feet in a South direction to the SE end line. This claim is  
marked by four monuments, one at each corner of the claim.

The location monument on which this notice is posted is situated within Section 28, Township  
15 N, Range 18 W, Gila Salt River Base and Meridian, Arizona. This claim encompasses  
portions of the following legal subdivision(s) if located by legal subdivision or the following quarter section(s),  
section(s), Township(s) and Range(s) SW 1/4, SW 1/4, 15N, 18W, Sec 28

\_\_\_\_\_, Gila Salt River Base and Meridian, Arizona.

The locality of this claim with reference to some natural object or permanent monument and additional information  
(if any) concerning its locality are as follows: 1320 ft North  
of Section 28, 29, 32, 33

\_\_\_\_\_. The above information is shown on the attached map.

DATED AND POSTED on the ground this 28 day of Jan, 2017.

☒ LOCATOR(s) ☐ AGENT

Print Name(s) Tina Heck Richard Blevins

Signature(s) Tina Heck Richard Blevins

Form MCF102  
Revised July 2014

This form is available from the Arizona Geological Survey and may be reproduced.

AMC441246



Lode ( ) Placer ( )  
Millsite ( )

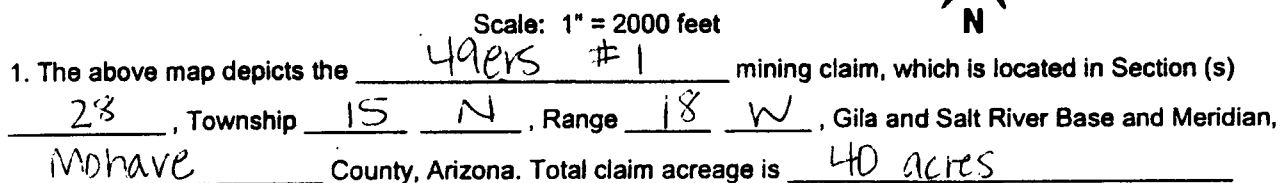

- Form MCF100a**  
**Revised July 2014**

RUN TIME: 10:46 AM

DEPARTMENT OF INTERIOR  
BUREAU OF LAND MANAGEMENT

RUN DATE: 02/01/2017

Input Parameters for Geographic Report with Land

System Id = CR

Admin State = AZ

Geo State =

Casetype =

Casetype Txt =

Case Disp Txt = AUTHORIZED, CANCELLED, EXPIRED, PENDING, REJECTED, RELINQUISHED, VOID, WITHDRAWN

Mer Twp Rng =

Mtrs = 14 0150N 0180W 028, 14 0150N 0180W 999

Commodity =

Commodity Txt =

Adm Agency Begins With

Total Rows Returned: 0

NO WARRANTY IS MADE BY BLM FOR USE OF THE DATA  
FOR PURPOSES NOT INTENDED BY BLM



## STATUS OF PUBLIC DOMAIN LAND AND MINERAL TITLES

MOHAVE COUNTY

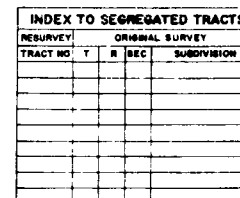

FOR ORDERS EFFECTING DISPOSAL OR USE OF  
UNIDENTIFIED LANDS WITHDRAWN FOR CLASSIFICATION,  
MINERALS, WATER AND/OR OTHER PUBLIC PURPOSES,  
REFER TO INDEX OF MISCELLANEOUS DOCUMENTS

***DIST NO 5***

GRAZING DIST. NO. 2

Lat 34°35'41" N  
Long 114°04'54" W

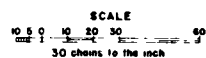

**WARNING STATEMENT**

**WARNING STATEMENT**  
This plat is the Bureau's Record of Title and should be used only as a graphic display of the township survey data. Records herein do not reflect title changes which may have been effected by lateral movements of rivers or other bodies of water. Refer to the cadastral surveys for official survey information.

[illegible]

T 15 N  
R 18 W